

EXHIBITOR INFORMATION

Northwest Law & Mental Health Conference

March 13, 2020 - Doubletree Hotel - Portland, Oregon

1000 NE Multnomah - Portland Oregon

www.olmhc.org - coordinator@olmhc.org

PO Box 3641 Portland, Oregon 97208 - 503-367-6128

Thank you for exhibiting at the 2020 Northwest Law & Mental Health Conference in Portland, Oregon.

The Northwest Law & Mental Health Conference will be March 13, 2020 at the Doubletree Hotel in Portland, Oregon.

The Conference brings together dozens of expert speakers with legal, clinical, and lived experience to discuss the confluence of law and mental illness.

The Northwest Law & Mental Health Conference is designed for attorneys and law enforcement, public and private clinicians; healthcare administrators; students of the law, social work, psychology and psychiatry; policy designers and elected officials; and companies and individuals involved with the care and welfare of people with mental illness.

The conference offers continuing education credit for clinicians through the National Association of Social Workers of Oregon, for attorneys through the Oregon State Bar Association, and for law enforcement through the Oregon State Department of Public Safety Standards And Training.

The full conference program will be available in December. The program includes thirteen credentialed sessions with expert presenters, morning and afternoon half-hour breaks and a keynote lunch. About 325 people will attend the conference. Registrations, sponsorships and exhibit space all sold out for this conference in 2017, 2018, and 2019.

Exhibitor hours are conference hours, 8 AM - 5 PM, on March 13. The area for exhibitors is open for load-in and set-up after 6 PM on March 12, or the morning of the conference. Tables are located in the lobby of the hotel, across from the registration table. To ensure full visibility and marketing to conference participants, exhibitors agree not to tear down before 4:30 PM. Tables are first come first served.

Set-up is in the area described in the map below as the "FOYER." Tables are 72" x 36". Each table is draped and will include two chairs. Tables and chairs can be removed on request.

Exhibitors may ship materials to the hotel no more than 72 hours in advance to avoid additional fees. Venue fees for delivery are - large envelope, no charge; package - \$5; pallet - \$50. Ship to the "Oregon Housing Conference" and contact hotel staff to retrieve materials. Shipping of exhibit materials to and from the conference site is at the expense and risk of the exhibitor.

No pins, tacks or adhesives of any kind are permitted on any hotel walls, doors or columns. Electrical wiring and equipment installation must conform to appropriate State codes. Hotel personnel are obligated to refuse connections where wiring is not in accordance with subject's code. Material not conforming to such regulations will be removed immediately at the hotels' request. Exhibitors who desire to carry insurance on their exhibits must do so at their own expense. All doors and openings must be kept clear.

Electricity is available - but bring an extension cord and duct tape to secure a cord if you need to run it some distance. Free wifi is available in the lobby and no password is required.

Park in the lot adjacent to the hotel. We will have coupons for free all-day parking at the registration table.

Let me know if you have further questions.

Jason Renaud - Conference Coordinator - 503-367-6128

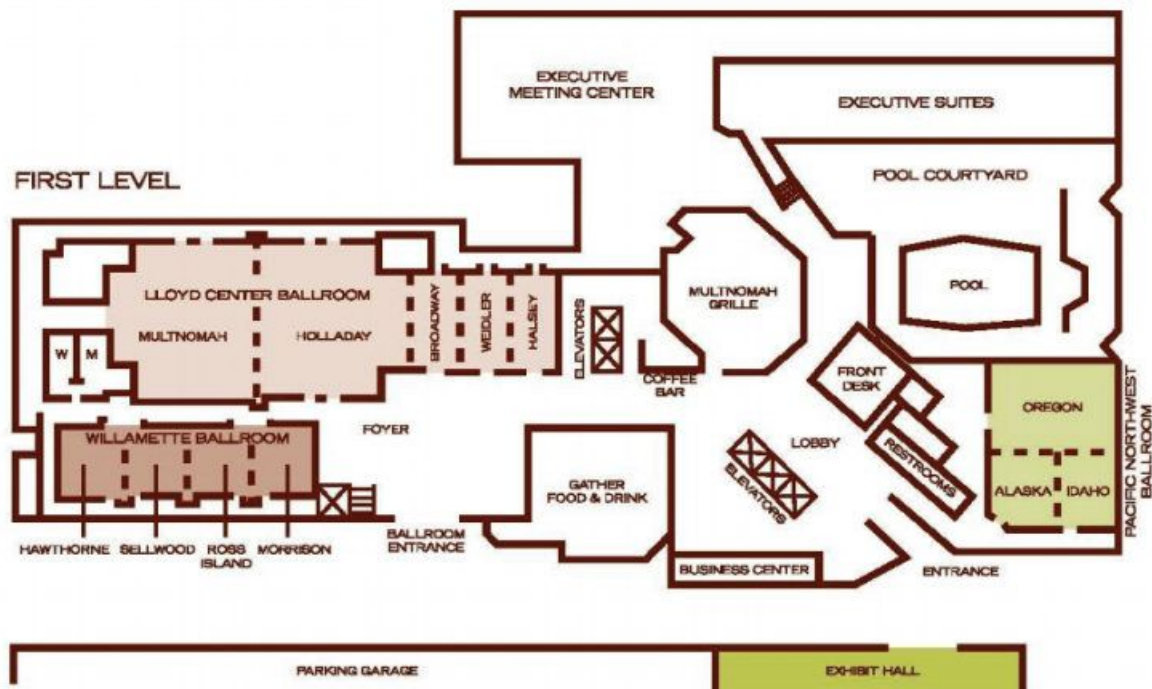

The Northwest Law & Mental Health Conference is a program of the Mental Health Association of Portland, Oregon's impartial and independent advocate for persons with mental illness and addiction. Our task is to help persons with mental illness or addiction speak up and speak out – and to speak for those who cannot speak for themselves. It is a nonprofit organization governed by peer volunteers since 2003. Learn more at www.mentalhealthportland.org